

CONTACT PAD PATTERNS

SINGLE-SIDED WITH LED (suitable for BL-series 4-leg domes)

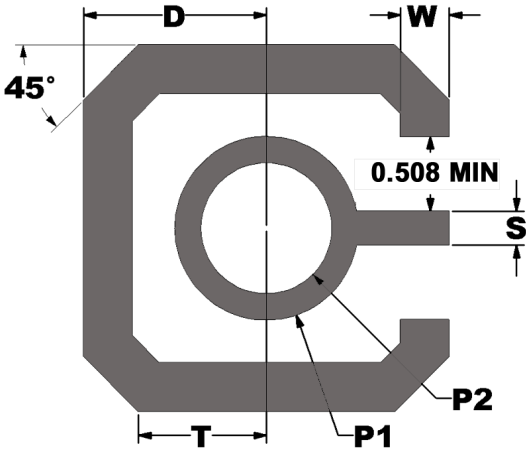

| DIAMETER | "D" | "T" | "W" | "P1" | "P2" | "S" |
|----------|------|------|------|------|-------------|------|
| 8.5mm | 4.19 | 2.77 | 1.09 | 3.48 | < Dome Hole | .092 |
| 10mm | 4.67 | 3.15 | 1.55 | 4.08 | < Dome Hole | 1.10 |
| 12mm | 5.59 | 3.76 | 1.85 | 4.90 | < Dome Hole | 1.30 |
| 14mm | 6.40 | 4.34 | 1.98 | 5.70 | < Dome Hole | 1.60 |

* Snaptron recommends that the circuit area under the dome be void of solder mask. The keep out area begins at the outside edge of the outer circuit pad that the dome is positioned on and includes area inside pads.

* These drawings represent one of many possible layouts. Snaptron conveys this information for our customer support with the intent that customers are responsible for the final design on the P.C.B. layout.